

Vehicle Tracking Key:

- Vehicle Chassis Outline
- Overhang of Vehicle
- Clearance (500mm)

Vehicle Specs

**Large Rigid Truck**  
 Truck Width: 2.50m  
 Lock to lock time: 6.00s  
 Track width: 2.50m  
 Vehicle Speed: 5 km/hr - 10 km/hr

Not to Scale

**NOT FOR CONSTRUCTION**

Vehicle Tracking Key:

- Vehicle Chassis Outline
- Overhang of Vehicle
- Clearance (500mm)

Vehicle Specs

**Semi Trailer**  
 Vehicle width: 2.50m  
 Lock to lock time: 6.00s  
 Track width: 2.50m  
 Turning radius: 10.0m  
 Vehicle Speed: 10 km/hr

Not to Scale

**NOT FOR CONSTRUCTION**

Vehicle Tracking Key:

- Vehicle Chassis Outline
- Overhang of Vehicle
- Clearance (500mm)

Vehicle Specs

**Medium Truck**  
 Truck Width: 2.50m  
 Lock to lock time: 6.00s  
 Track width: 2.50m  
 Turning radius: 10.0m Vehicle  
 Speed: 5 km/hr - 10 km/hr

Not to Scale

**NOT FOR CONSTRUCTION**



## Kitchener Road/Fenwick Avenue/Shakespeare Road Intersection Improvements Vehicle Tracking

ORIGINAL SCALE		1:400 A3
SHEET	DRAWING No.	REVISION
1	ATOP161-03-001	A
OF		
2	Service Order Number	A3
SHEETS	SO-393	ORIGINAL

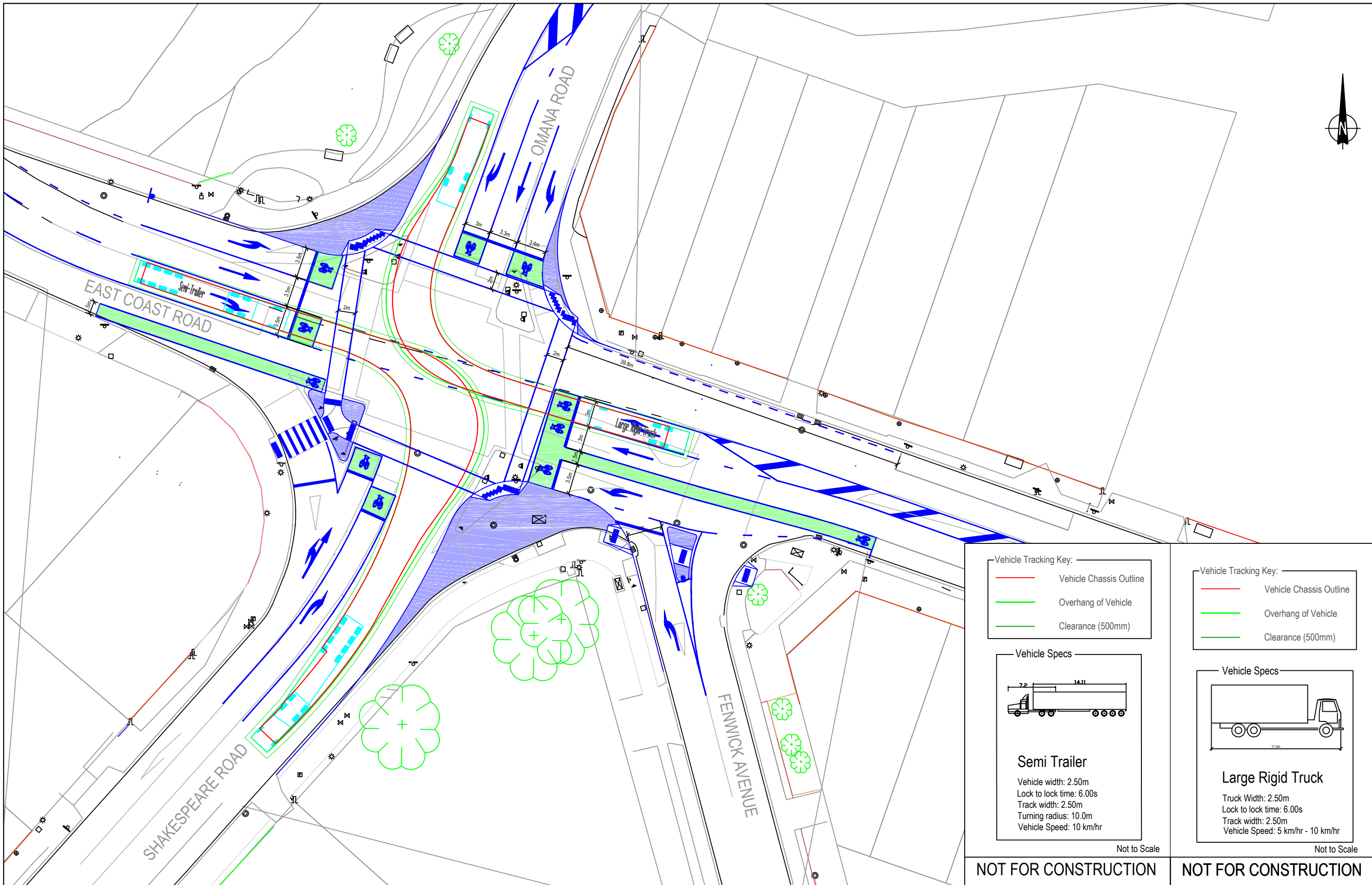

Vehicle Tracking Key:

- Vehicle Chassis Outline
- Overhang of Vehicle
- Clearance (500mm)

Vehicle Specs

**Semi Trailer**  
 Vehicle width: 2.50m  
 Lock to lock time: 6.00s  
 Track width: 2.50m  
 Turning radius: 10.0m  
 Vehicle Speed: 10 km/hr

Not to Scale

NOT FOR CONSTRUCTION

Vehicle Tracking Key:

- Vehicle Chassis Outline
- Overhang of Vehicle
- Clearance (500mm)

Vehicle Specs

**Large Rigid Truck**  
 Truck Width: 2.50m  
 Lock to lock time: 6.00s  
 Track width: 2.50m  
 Vehicle Speed: 5 km/hr - 10 km/hr

Not to Scale

NOT FOR CONSTRUCTION



## Kitchener Road/Fenwick Avenue/Shakespeare Road Intersection Improvements Vehicle Tracking

ORIGINAL SCALE		1:400 A3
SHEET	DRAWING No.	REVISION
2	ATOP161-03-001	A
OF		
2	Service Order Number	A3
SHEETS	SO-393	ORIGINAL